



PER MONTH 845 SQUARE FEET

PER MONTH 872 SQUARE FEET

ORCHARD LAKES

ASHLEY WITH ALTERNATIVE

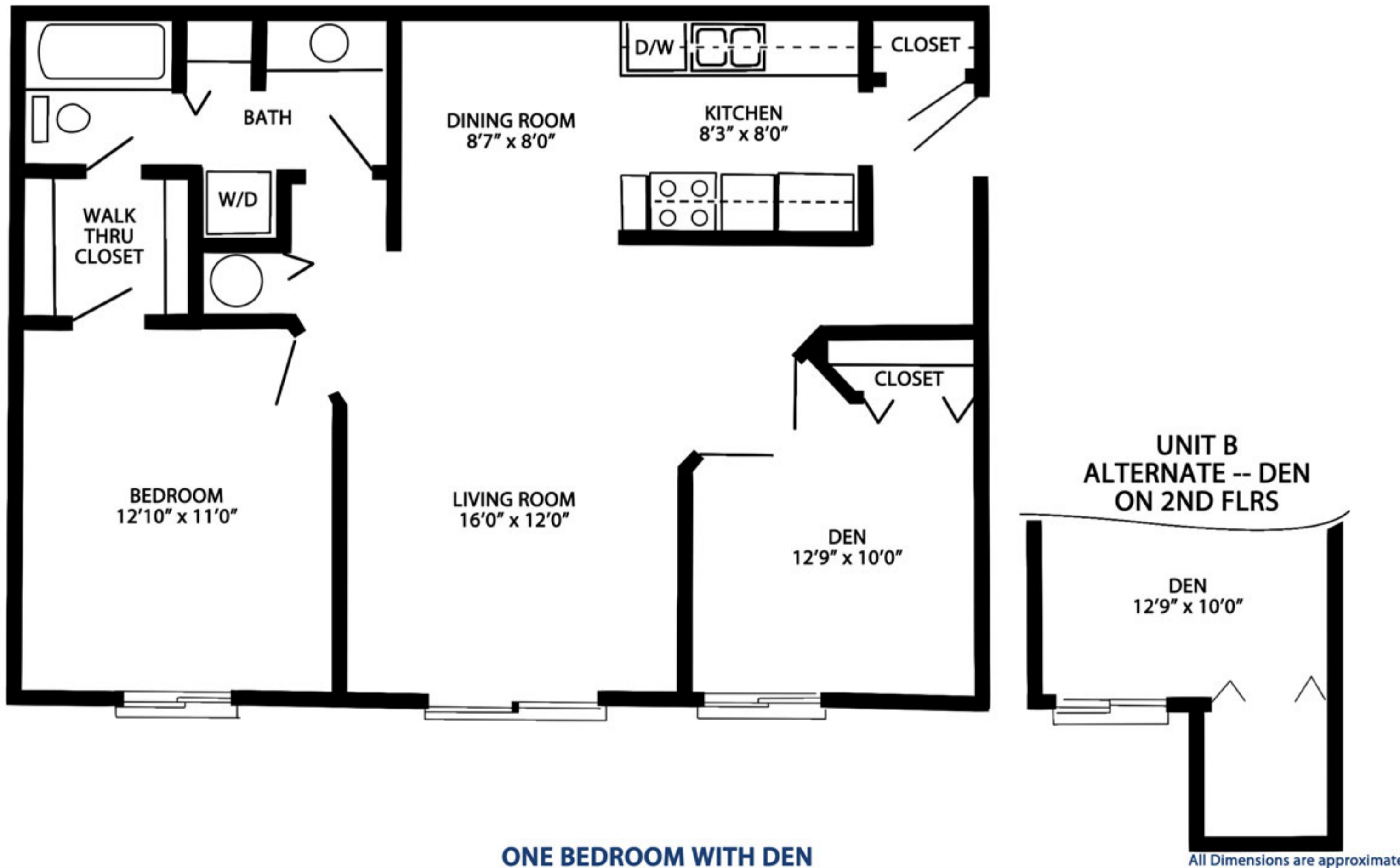

APARTMENT LOCATION

154 Juliann Drive
Wood Dale, IL 60191

COMMUNITY FEATURES

- Garage Rentals Available
- 24 - Hour Fitness Center
- Fully Furnished Club House (Resident Rental Avail)
- Swimming Pool W/ Sun Deck
- Tennis Courts
- 24- Hour Emergency Maintenance
- On-Site Management Office
- Close To Restaurants Shops
- Large Community Court Yard W/ Lake And Fountain
- Short Distance From O'Hare
- Close To Major Expressways
- Participate in the Crime Free Housing Program

OFFICE PHONE

630-350-7979

